

SL-ZAKD 80(128)A...
SL-ZIKD 100A...
SL-ZIKD 63A...
SL-AKS/Z 63(100)A...

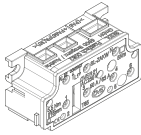

SL-ZAKW 63(100)A...

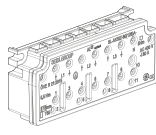

SL-AKS/Z 80(128)A...

- | | |
|---------------------------------------|--------------------------------|
| de Originalbetriebsanleitung | fi Alkuperäiset ohjeet |
| en Original instruction | no Original bruksanvisning |
| fr Notice originale | da Original brugsanvisning |
| nl Oorspronkelijke gebruiksaanwijzing | pl Instrukcja oryginalna |
| it Istruzioni originali | hu Eredeti használati utasítás |
| es Manual original | sv Bruksanvisning i original |
| pt Manual original | |



i SL-ZAKD 80(128)A...
SL-ZIKD 100A...
SL-ZIKD 63A...

Md = 5 Nm

1/3/4/6/7/9/10/12 18mm

Md = 5,5 Nm

2/5/8/11 Md = 0,5 Nm

i SL-ZAKD 80(128)A-1N+7xTRE

Md = 5 Nm

1/3/4/6/7/9/10 18mm

Md = 5,5 Nm

L1↑L1↓L2↑L2↓L3↑L3↓/N Md = 0,5 Nm

i SL-AKS/Z 63(100)A...

Md = 5 Nm

1/3/4/6/7/9/10/12 18mm

Md = 5,5 Nm

2/5/8/11 Md = 0,5 Nm

i SL-AKS/Z 80(128)A...

Md = 5 Nm

1/3/4/6/7/9/10/12 18mm

Md = 5,5 Nm

2/5/8/11 Md = 0,5 Nm

i SL-ZAKW 63(100)A...

Md = 5 Nm

1/3/4/6 18mm

Md = 5,5 Nm

2/5 Md = 0,5 Nm

rigid solid ✓

rigid stranded ✓

flexible without ferrule ✗

flexible with ferrule ✓

For detailed information see QM-TH-001 Leiteranschluss!
For detailed information see QM-TH-001 wire connection!

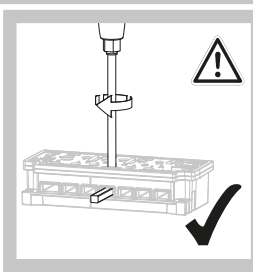
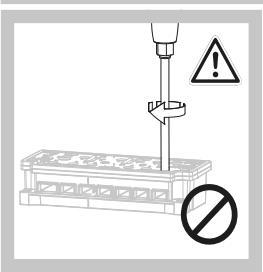

i 2N

Leiter gerade in die Anschlussstelle einführen!
Insert conductor straight in the connection!

Sicherheitshinweis:
Schalten Sie die Anlage spannungsfrei

Montage Zähleranschlussklemme
(Bild 1 - 7)

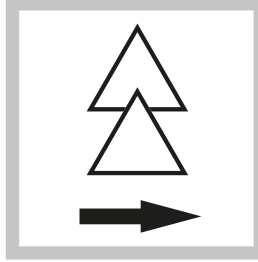
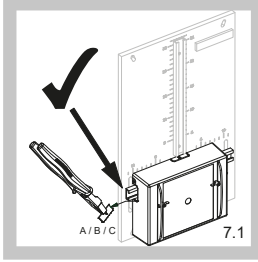
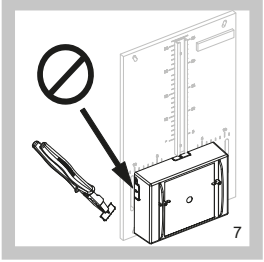
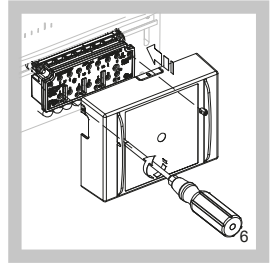
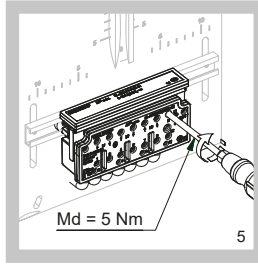
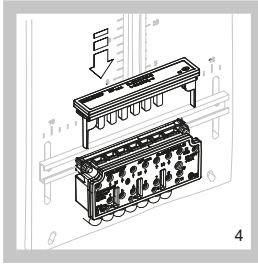
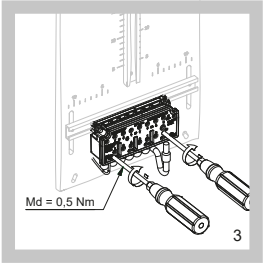
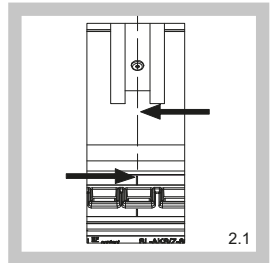
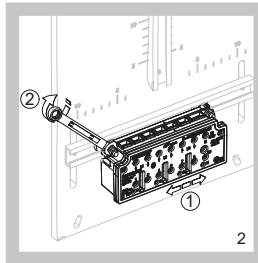
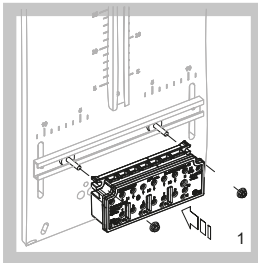

Montage Smartmeter / Energiezähler
(Bild 8 - 15)

